

VPN with AnyConnect on iOS

The steps below will create a secure virtual private network (VPN) connection back to Appalachian State University's network.

Requirements:

- iOS Device (iPhone, iPad, iPod Touch)
- The AnyConnect App (available through Self Service)
- An Internet Connection

After installing the AnyConnect application on the iOS device:

1. Tap the **AnyConnect App** on your device.

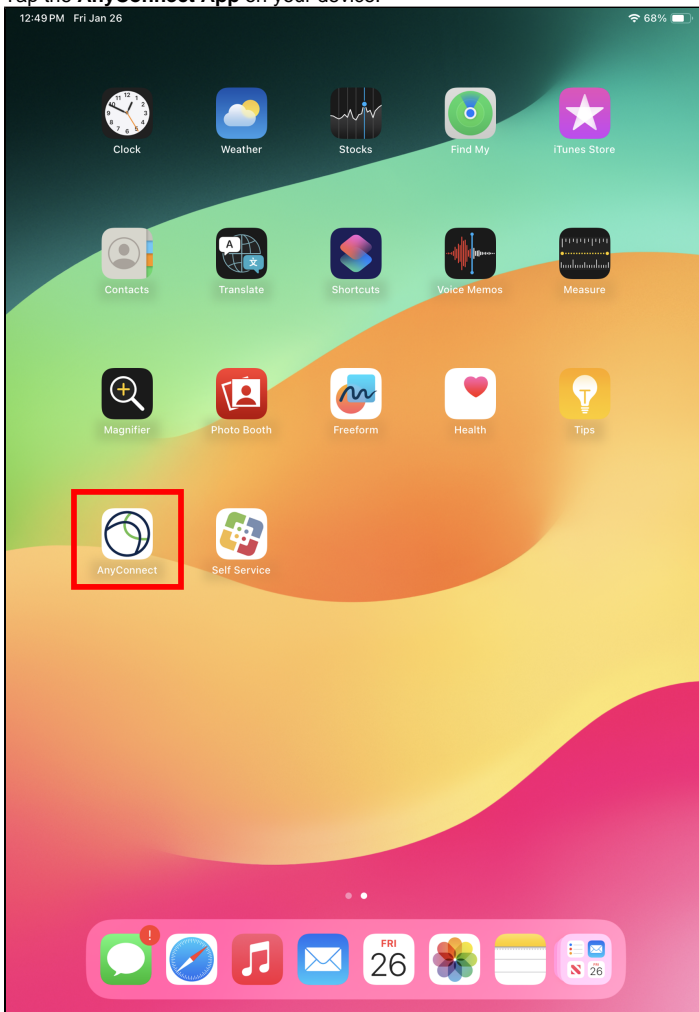

2. Once open, navigate to the top left corner, select the **sidebar icon**, and click the **Connections** tab.

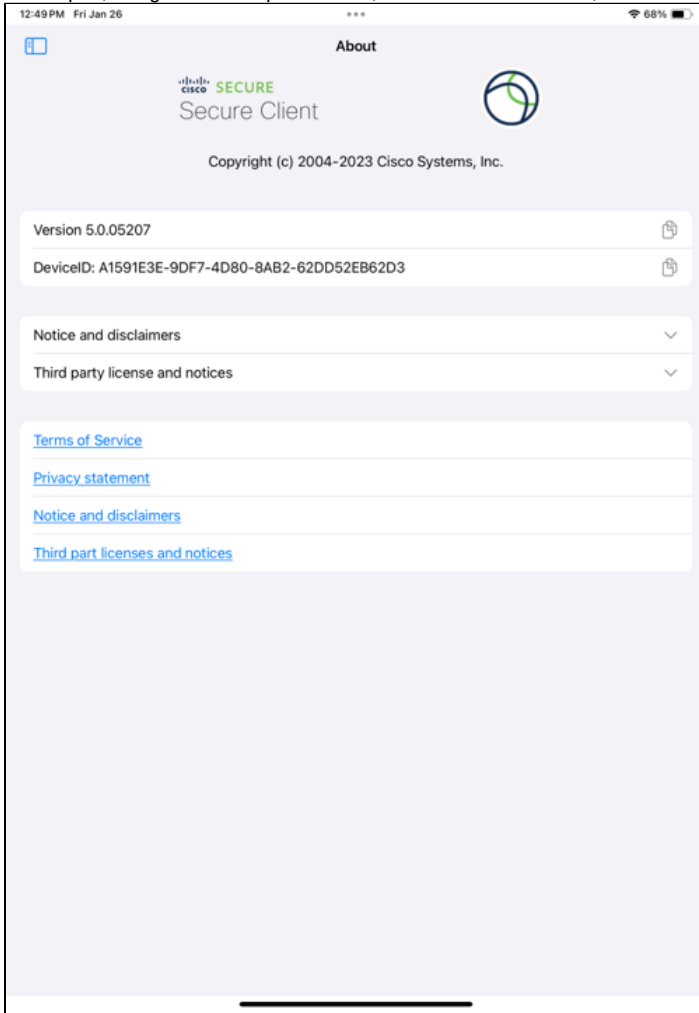

3. Select **Add VPN Connection**.

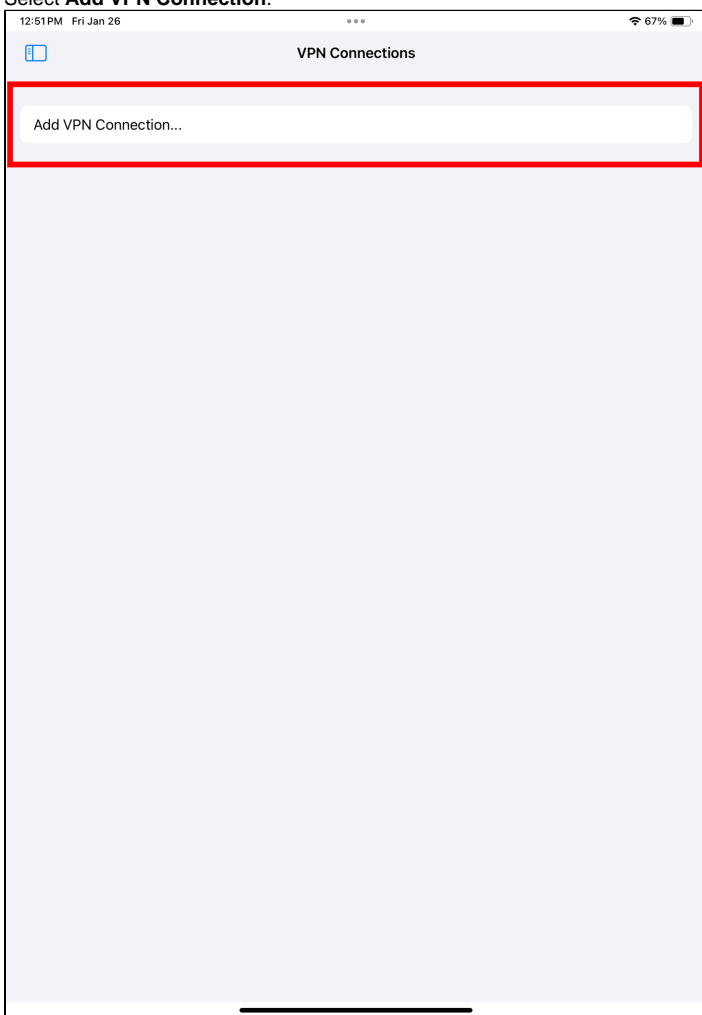

4. Enter "APPSTATE VPN" as the **Description** and "vpn.appstate.edu" as the **Server Address**.

12:51 PM Fri Jan 26 67%

Cancel Add VPN Connection... Save

Description APPSTATE VPN

Server Address vpn.appstate.edu

Certificate Automatic >

App Rules >

Connect On Demand ☐

TUNNEL PROTOCOL

Connect with IPsec ☐

Only enable 'Connect with IPsec' if instructed to do so by your administrator. If the server is not configured for IPsec, you will not be able to connect.

tab Q W E R T Y U I O P delete

caps lock A S D F G H J K L next

shift Z X C V B N M , . ? shift

.?123 .?123

5. If prompted, select **Allow** for the following popup. A new window will then be opened and ask for the device's passcode.

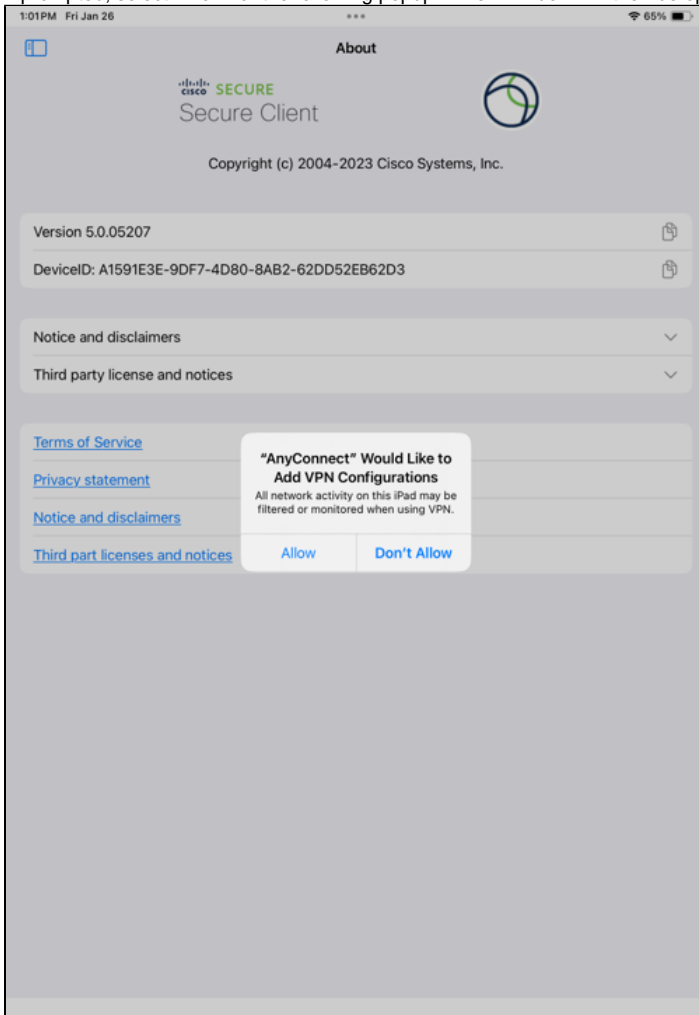

Enter iPad Passcode
Add VPN Configurations



1	2 ABC	3 DEF
4 GHI	5 JKL	6 MNO
7 PQRS	8 TUV	9 WXYZ
	0	Cancel

6. Once the VPN is enabled, navigate back to the sidebar and swipe the toggle next to **AnyConnect VPN** to enable it.

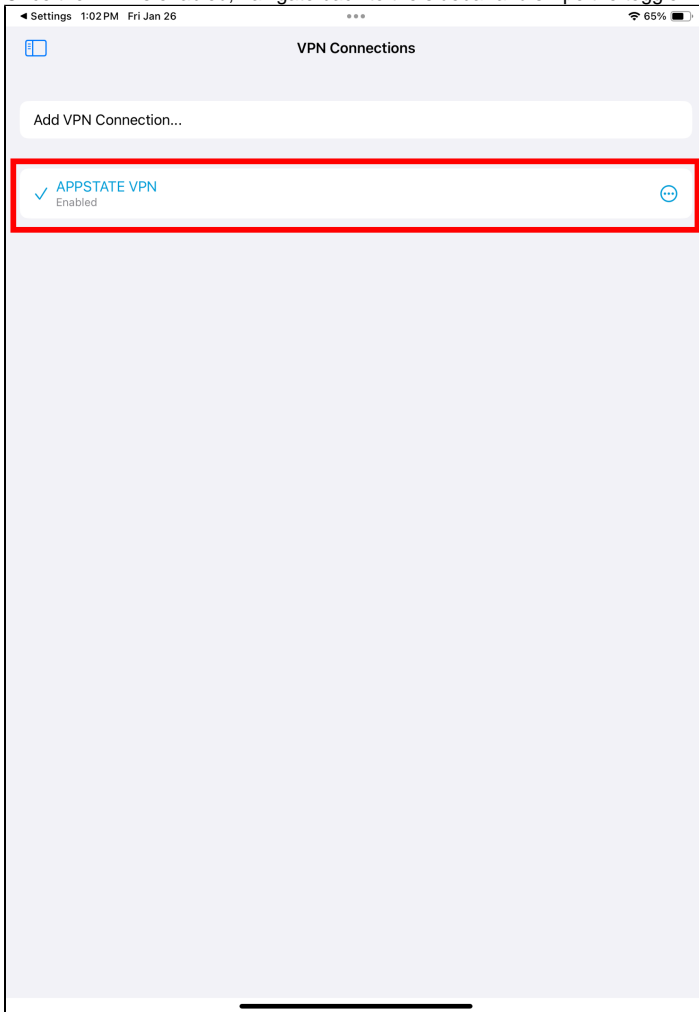

7. Enter your App State credentials to log in. **DO NOT** enter the @appstate.edu in the username field. Two-factor authentication is used. confirm your push notification from Duo Mobile.

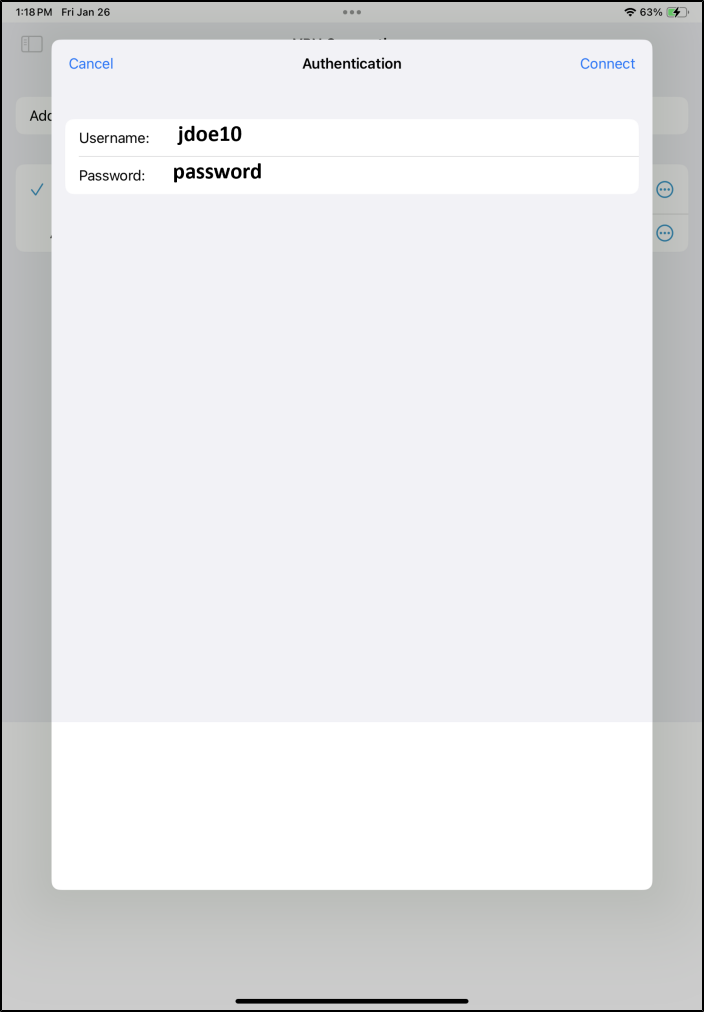

8. Press **Accept** on the final popup.

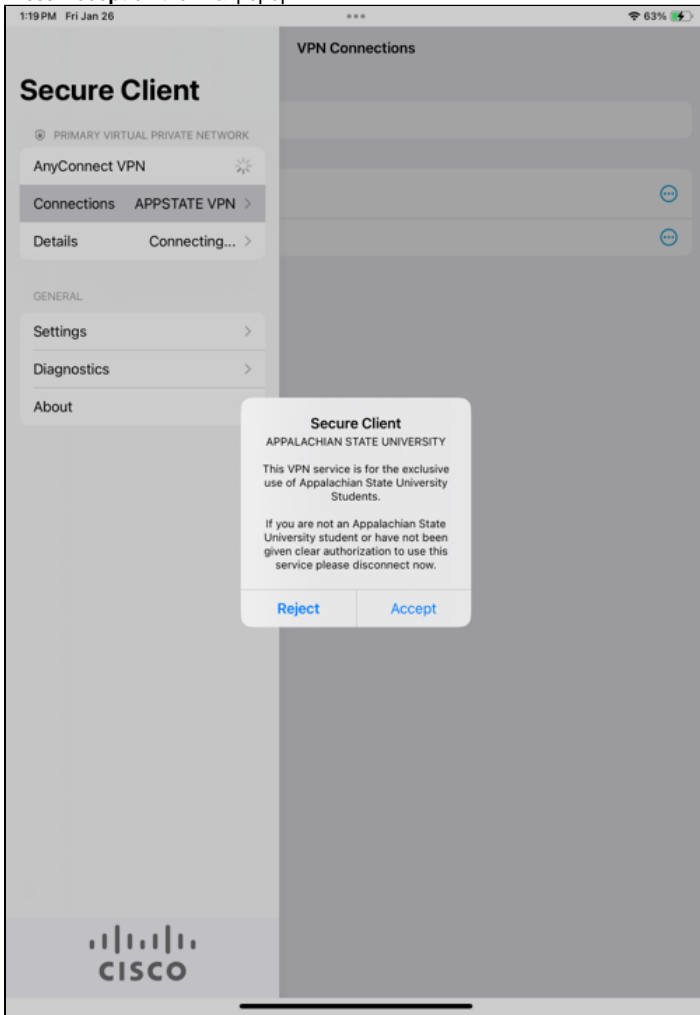

Important Notes:

- DO NOT put the @appstate.edu in the username field.
- Also, if this is the first time you have EVER used the App State VPN system (on your mobile device or computer). You may need to [change your password](#) if you are unable to log in.
- After signing in, you are now tunneled into the App State network. You will now be able to access any internal services via your device as long as you are connected.
- Remember to log out after completing your work. You will be held responsible for any damages or service outages caused by you, your device, or your account while using this service.

App State, Information Technology Services, or Technology Support Services will not be held responsible for any damages or additional charges they may apply while using this service. Use this service and application at your own risk.

Related Articles

- [Apple](#)
- [How to Configure ASU Wireless on iOS Devices.](#)
- [How to Purchase Apps in Apple School Manager](#)
- [How to Update Software on macOS](#)
- [How to Upgrade macOS](#)
- [Requesting App Licenses for Managed Apple Devices](#)
- [Setting up MountaineerApps on iOS with Google's Apps](#)
- [Upgrade iOS on your Mobile Device](#)
- [Using Apple Configurator to Update Multiple iPads at Once](#)
- [Using Self Service on an iOS Device](#)

Visit or call the [Technology Support Center](#) for assistance with your iOS Devices.

[Search Knowledge Base](#)

[Submit a Service Request](#)

We value your feedback! Click [HERE](#) to suggest updates to an existing article, request a new article, or submit an idea.